



# 深圳市金驹科技有限公司

## Shenzhen Jinju Technology Co., Ltd.

### 承认书

### ACKNOWLEDGMENT

客户名称 ( client's name ) : \_\_\_\_\_

客户料号 ( Customer item number ) : \_\_\_\_\_

产品型号 ( Product number ) : JJ-D92430CE

产品名称 ( product name ) : DC-DC 恒流驱动电源

编制日期 ( Date of preparation ) : \_\_\_\_\_

制定 (Formulate)	审核 (Review)	批准 (Approve)
承认 (Admit)	审核 (Review)	批准 (Approve)

厂商: 深圳市金驹科技有限公司

地址: 深圳市龙城街道龙西社区清水路鹏大地工业区14栋4楼

电话: 0755 - 84861299 传真: 0755 - 84860299

邮箱: 2880362299@qq.com 网址: <http://www.szjpower.cn/> <http://www.szjjled.com/>

Manufacturer: Shenzhen Jinju Technology Co., Ltd.

Address: 4th Floor, Building 14, Peng Dadi Industrial Zone, Qingshui Road, Longxi Community, Longcheng District, Shenzhen

Tel: 0755 - 84861299 Fax: 0755 - 84860299 E-mail: [2880362299@qq.com](mailto:2880362299@qq.com)

Website: <http://www.szjpower.cn/> <http://www.szjjled.com/>

## 产品描述:

★本款电源是一款高品质、高稳定性的LED防水恒流驱动电源。内部滤波器件采用绿宝石，核心元器件都是IR进口，以保证产品的质量和可靠性。具有启动快速，兼容负载范围宽，保护功能齐全，采用国际知名大厂成熟方案，DC12-24V输入，DC28-36V输出，高精度的恒流控制，极高的效率和可靠的性能，以及小型的外观结构会使你的灯具更加趋于完美。

## 产品特点:

- ★输入DC12-24V，加防反接保护功能。
- ★输出DC28-36V，恒流0.9A。
- ★输出开路、短路、过压、过温保护。
- ★可做调光功能。
- ★装配尺寸小，可适用于各种需安全供电的场合使用。
- ★采用LED专用防水环氧树脂AB胶，通过导热胶与铝壳接触，散热效果极佳，室内户外均可使用，两端各设两个机械固定孔位，适用于多种内部安装应用。

## Product description:

★This power supply is a high-quality, high-stability LED waterproof constant current drive power supply. The internal filter parts are made of emerald, and the core components are all imported from IR to ensure the quality and reliability of the product. It has fast start-up, wide compatible load range, complete protection function, adopts mature solutions from internationally renowned manufacturers, DC12-24V input, DC28-36V output, high-precision constant current control, extremely high efficiency and reliable performance, and small appearance structure It will make your lamps more perfect.

## Product characteristics:

- ★Input DC12-24V, add anti-reverse connection protection function.
- ★Output DC28-36V, constant current 0.9A.
- ★Output open circuit, short circuit, over voltage, over temperature protection.
- ★Can be used for dimming function.
- ★Small assembly size, suitable for various occasions requiring safe power supply.
- ★Use LED special waterproof epoxy resin AB glue, contact with the aluminum shell through thermal conductive glue, excellent heat dissipation effect, can be used indoors and outdoors, two mechanical fixing holes at each end, suitable for a variety of internal installation applications.

# 电气规格(Electrical Specifications):

产品型号		JJ-D92430CE			
输入参数	输入电压	DC12-24V	环境特性	工作温度	- 20~+65°C (DC24V)
	输入电流	3A		工作湿度	20~80%RH
				耐震动	10~500HZ, 2G, 10min/周期, X、Y、Z方向各60min
				温度系数	±0.05%/°C (0~60°C)
				储存温度/湿度	- 40~+85°C 10~95%RH
输出参数	输出电压	28-36V (10串)	其他	电磁干扰	设计参考: EN55015
	输出电流	0.9A		寿命	>100000H (25°C )
	电流精度	±3%		质保	3年
	额定功率	30W		平均无故障工作时间	>200000H
	效率	87-92%		裸机尺寸	L*W*H: 69*29*17mm
	线性调整率	±2%		半铝防水尺寸	L*W*H: 98*34*21mm
	负载调整率	±2%		包装方式	中性包装
	启动/上升时间	18ms			
	断电保持时间	15ms			
输入保护	防反接	反接不通电, 不损坏电源			
输出保护	短路	输出无电流, 异常条件移除后可自动恢复			
	开路	开路电压自动限制在42V±2V			
	过温	100°C±10°C 保护模式: 输出降电流 (外壳表面温度)			
	过压	保护模式: 输出降电流			
注	* 为了延长使用寿命, 建议配置负载时多留30%的余量。 * 所有电气性能测试均在25°C环境下完成, 如未特别说明, 所有规格参数均在DC24V, 环境温度25°C测量。				

## 电性参数(Electrical parameters):

参数(Parameter)		Min	Typ	Max	Min	Typ	Max	Min	Typ	Max	单位(Unit)
输入参数 Input parameter	输入电压(Input voltage)	12			18			24			V
	空载功率(Standby power)	0.36			0.54			0.24			W
	输入电流(Input current)	2.38	2.73	3.01	1.53	1.75	1.98	1.14	1.3	1.47	A
	输入功率(Input power)	28.56	32.76	36.12	27.5	31.5	35.6	27.4	31.2	35.3	W
输出参数 Output parameter	输出电压(Output voltage)	28	32	35	28	32	36	28	32	36	V
	输出电流(Output current)	0.9	0.9	0.9	0.9	0.9	0.9	0.9	0.9	0.9	A
	输出功率(Output power)	25.2	28.8	31.5	25.2	28.8	32.4	25.2	28.8	32.4	W
	效率(Efficiency)	88	88	87	92	91	91	92	92	92	%

## 产品适用范围(Scope of application):

灯珠串并 (String and parallel)	10-12串9并 (10 series 1 parallel)		
输出电压 (Output voltage)	28-42V		
输出电流 (Output current)	1*900mA		

## 热成像图(Thermography):

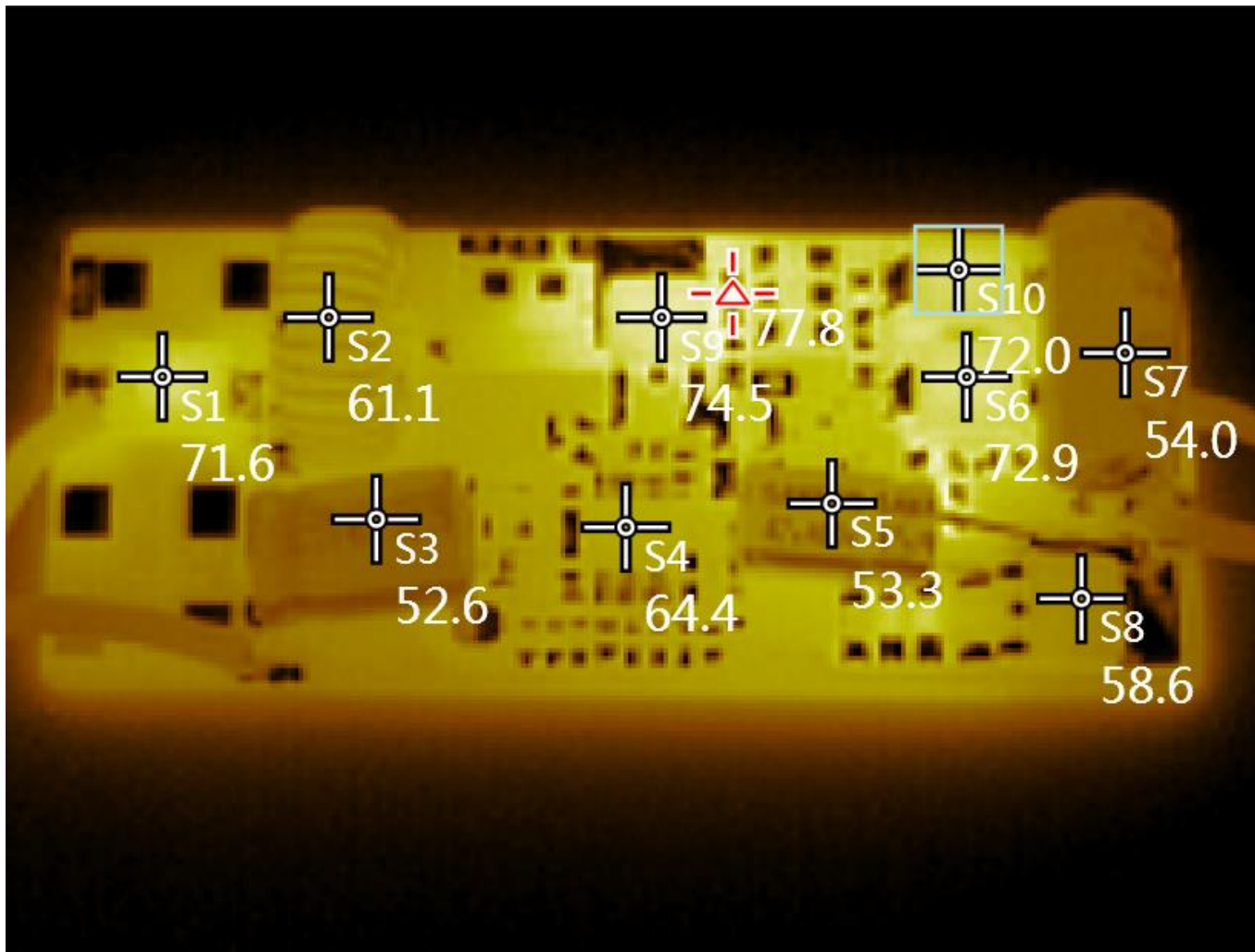

S1:防反接管(Anti reverse connection)

S2:电感(Inductance)

S3:输入滤波电容(Input filter capacitor)

S4:电源芯片(Power chip)

S5,S7 :输出滤波电容(Output filter capacitor)

S6,S10:续流二极管(Freewheeling diode )

S8, S9 :功率MOS管(Power MOS tube)

注: 环境30°C, 湿度<75%。输入DC24V, 输出32V长时间老化测得。

Note: The environment is 30°C, and the humidity is less than 75%. Input DC24V, output 32V long-term aging test.

# EMI测试曲线图(EMI test curve):

## EMI TEST REPORT

Organization:	Operator:	EUT:
Place:	Time: 2020/5/21/17:17	Test equipment:KH3939
Detector: PK	Test-time(ms): 30	SN: 390449
Limit: EN55015CDN	Transductor(PK/AV): CDN / CDN	JZ: 2,14,1534
Remark:		

Start(MHz)	End(MHz)	Step(MHz)
30.000	100.000	0.100
100.000	230.000	0.200
230.000	300.000	0.200

dBuV

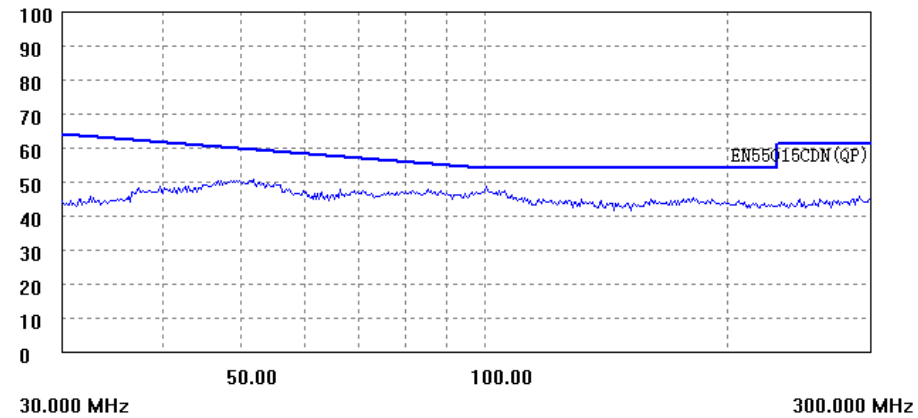

注：此图仅供参考，不同的灯具会有所差异。

Note: this drawing is only for reference. Different lamps will be different.

# 安装尺寸图(Installation dimension drawing):

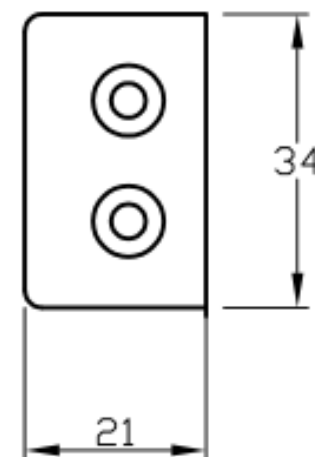
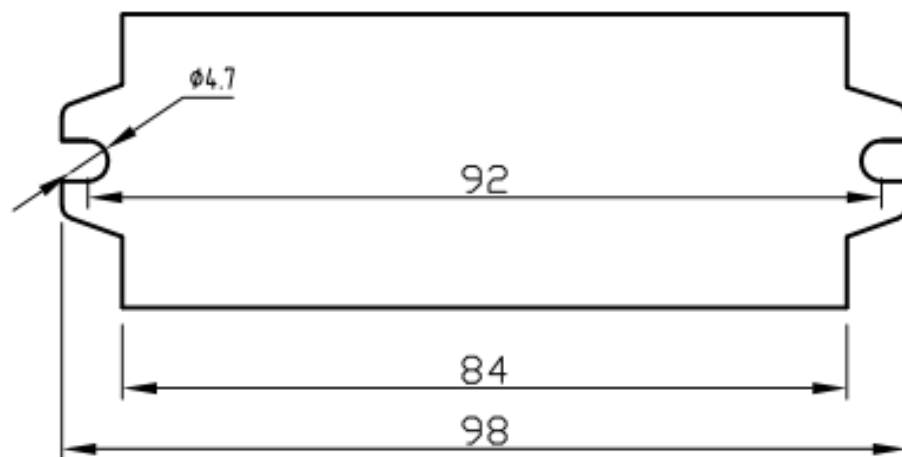

Unit: mm



## 产品使用说明(Product instructions ):

- ★本产品主要应用于LED灯具（照明灯，景观灯，水底投光灯、太阳能路灯等），整机功率为**30W**。
  - ★本产品是长形设计，操作时避免产品变形。产品两段各有两条电缆线，电源输入端是直流电输入，对应标贴纸上DC“V+”和DC“V-”，另一端标贴纸上标有“LED+”、“LED-”，“LED+”为输出正端，接LED正极，“LED-”为输出负端，接LED负极。
- 使用时请注意安全，防止触电，避免与金属短路，必须用绝缘材料套好后方能放入灯具内。

注：在使用本电源时，请注意区分输入端和输出端，确保正确接线，核对无误后才能通电。

注：请确保输入线正负极不接反，确认无误，再开电源。

注：请先接好DC输出端的负载，确认无误，再开电源

- ★ The product is mainly used in LED lamps (lighting, landscape lights, underwater projection lights, solar street lights, etc.), with a total power of **30W**.
- ★ This product is designed to be long and avoid deformation during operation. There are two cables in each section of the product. The power input end is DC input, corresponding to DC "V +" and DC "V -" on the label, "Led +" and "led -" are marked on the other end of the sticker, "Led +" is the output positive terminal, connected to the LED positive terminal, "Led -" is the output negative terminal, connected to the LED negative terminal. Please pay attention to safety when using, prevent electric shock, avoid short circuit with metal, and put it into the lamp only after being covered with insulating material.

Note: when using this power supply, please pay attention to distinguish the input terminal and output terminal, ensure the correct wiring, and power on after checking. Note: please make sure that the positive and negative poles of the input line are not connected reversely, and then turn on the power supply. Note: please connect the load of DC output terminal, confirm it is correct, and then turn on the power supply.

## 常见故障及处理方法(Common faults and Solutions ):

### 灯具不亮👉

Lamps and lanterns  
are not bright

请切断DC输入端并检查:

Please cut off the DC input and check:

1.DC输出端是否接触不良;

Whether the DC output terminal is in poor contact;

2.DC输出端正负极是否接反;

Whether the positive and negative poles of DC output end are connected reversely;

3.DC输入端是否接触不良;

Whether the DC input is in poor contact;

4.DC输入供电电源, 功率是否够大, 能否正常带的起**30W**负载。

Whether the power of DC input power supply is large enough and whether it can normally carry **30W** load.

排除以上故障后再测试。

Remove the above faults before testing.

### 灯具抖动👉

Lighting flicker

请切断DC输入端, 检查DC输出端:

Please cut off the DC input and check the DC output:

1.有无过载、超载;

Whether there is overload or overload;

2.电源设计参数与实际使用参数不符。

The power supply design parameters are inconsistent with the actual use parameters.

注: 产品在使用过程中如遇到其它疑问和问题, 请及时与我司沟通、反馈不良信息, 我司将积极助贵公司解决好问题。

Note: in case of any other questions and problems during the use of the product, please communicate with our company in time and feed back the bad information. Our company will actively help your company to solve the problems.