



# 深圳市金驹科技有限公司

## Shenzhen Jinju Technology Co., Ltd.

### 承认书

### ACKNOWLEDGMENT

客户名称 ( client's name ) : \_\_\_\_\_

客户料号 ( Customer item number ) : \_\_\_\_\_

产品型号 ( Product number ) : JJ-5324100

产品名称 ( product name ) : RGB DC-DC 恒流驱动电源

编制日期 ( Date of preparation ) : \_\_\_\_\_

制定 (Formulate)	审核 (Review)	批准 (Approve)
承认 (Admit)	审核 (Review)	批准 (Approve)

厂商: 深圳市金驹科技有限公司  
 地址: 深圳市龙城街道龙西社区清水路鹏大地工业区14栋4楼  
 电话: 0755 - 84861299 传真: 0755 - 84860299  
 邮箱: 2880362299@qq.com 网址: <http://www.szjpower.cn/> <http://www.szjjled.com/>

Manufacturer: Shenzhen Jinju Technology Co., Ltd.  
 Address: 4th Floor, Building 14, Peng Dadi Industrial Zone, Qingshui Road, Longxi Community,  
 Longcheng District, Shenzhen  
 Tel: 0755 - 84861299 Fax: 0755 - 84860299 E-mail: [2880362299@qq.com](mailto:2880362299@qq.com)  
 Website: <http://www.szjpower.cn/> <http://www.szjjled.com/>

## 产品描述:

★本款产品是一款高稳定性LED/RGB/DC-DC恒流驱动电源。内部滤波器件使用品牌绿宝石电容，高频低阻，105°C高温下，时长8000H（部分10000H），低温时间更长。专利的核心元件，较宽的电压输入，高精度的恒流输出，完善的保护功能，以及超薄的外观结构会使您的灯具更加趋于完美。

★本产品采用集成电路设计方案，输出采用芯片恒流。具有超高的恒流精准度，及线路板合理的布局，使产品在工作中温升大大降低，从而提高产品的稳定性能。

★比市面上采用传统的1+1方式（开关电源+程序控制小板）在效率和恒流上都有很大的优势，市面上的都是采用1+1的控制模式，及小板上面都是采用色环电阻限压恒流。这种方案成本低廉，而且由于色环电阻的特性，造成此类产品的输出电流会因长时间点亮造成色环电阻升温，内部阻值的变化而改变电流并且浮动大。对灯珠影响非常大，大大的降低了使用寿命及灯具光衰问题。

## product description::

★ This product is a high stability LED / RGB / DC-DC constant current drive power supply. The internal filter uses brand emerald capacitor, high frequency and low resistance. At 105 °C high temperature, the time is 8000h (part 10000h), and the low temperature time is longer. Patented core components, wide voltage input, high-precision constant current output, perfect protection function, and ultra-thin appearance structure will make your lamps more perfect.

★ This product adopts integrated circuit design scheme, and the output adopts chip constant current. With high constant current accuracy and reasonable layout of the circuit board, the temperature rise of the product during operation is greatly reduced, thereby improving the stability of the product.

★ Compared with the traditional 1+1 mode (switching power supply + program control small board) on the market, it has great advantages in efficiency and constant current. The market adopts 1+1 control mode and small board. It is a color-limiting resistor that limits the constant current. This kind of scheme is low in cost, and due to the characteristics of the color ring resistance, the output current of such products may cause the color ring resistance to rise due to long-time lighting, and the internal resistance changes to change the current and fluctuate greatly. It has a great influence on the lamp bead, which greatly reduces the service life and the light decay of the lamp.

## 产品特点:

- ★输入直流DC24V。
- ★集成度高，输出3路R G B 单独恒流，每路电流可单独定义（根据客户需求）。
- ★R G B 三组输出采用共正极的方式连接。
- ★输出开路，短路，过压，过温保护。
- ★采用LED专用防水环氧树脂AB胶，通过导热胶与铝壳接触，散热效果极佳，满负载输出时外壳表面温度不超过70°C(在环境25°C测量),室内户外均可使用，两端各设两个机械固定孔位，适用于多种内部安装应用。

## Features :

- ★ Input DC 24V.
- ★ High integration, output 3 R G B separate constant current, each current can be defined separately (according to customer needs).
- ★ The R G B three sets of outputs are connected in a common positive mode.
- ★ Output open circuit, short circuit, over voltage, over temperature protection.
- ★ LED special waterproof epoxy resin AB glue, through the thermal adhesive and aluminum shell contact, the heat dissipation effect is excellent, the surface temperature of the shell when the full load is output does not exceed 70 ° C (measured in the environment 25 ° C), indoor and outdoor can be used, both ends Two mechanical mounting holes are available for a variety of internal mounting applications.

## 电气规格 (Electrical specifications) :

产品型号		JJ-5324100
输入参数	输入电压	DC24V
	输入电流	4A
	效率	94%-95%
输出参数	额定功率	100W
	输出电压	12-20V
	电流范围	3路 1.6-1.8A
	电流精度	±3%
	线性调整率	±2%
	负载调整率	±2%
	输出纹波	<5%
输出保护	短路	输出无电流, 异常条件移除后可自动恢复
	开路	不接LED时, 自动限制在24V±2V
	过温	100°C±10°C 保护模式: 输出降电流 (外壳表面温度)
	过压	保护模式: 输出降电流
环境特性	工作温度	-20°C ~ 65°C (AC220)
	工作湿度	20 ~ 80%RH
	耐震动	10 ~ 500HZ, 2G, 10min/周期, X、Y、Z方向各60min
	温度系数	±0.05%/°C (0-60°C)
	储存温度/湿度	-40 ~ 85°C 10~95%RH
其他	寿命	> 100000H (25°C)
	质保	3年
	平均无故障工作时间	> 200000H
	裸机尺寸:	长: 56 宽: 62 高: 23MM, 175g±5g
	全铝防水尺寸:	长: 123 宽: 63 高: 40MM, 470g±5g
	包装方式:	

注: \* 为了延长使用寿命,建议配置负载时多留30%的余量。例如:设备需要50W的功率,则应选用不小于80W的电源。

\* 电源纹波测试方法: 示波器带宽限制在20MHz, 示波器探头接地使用弹簧针, 并在探头输入并联47uF电解电容和0.1uF陶瓷电容。

\* 所有电气性能测试均在25°C环境下完成, 如未特别说明, 所有规格参数均在230VAC, 环境温度25°C测量。

## 电性参数 (Electrical parameters) :

	参数(parameter)	典型负载(Typical load)	单位(unit)
输入总功率 Input total power	输入电压(Input voltage)	DC24	V
	输入电流(Input Current)	3.963	A
	输入功率(input power)	95.11	W
	待机功率(Standby power)	2.88	W
	输出电压(The output voltage)	12-20	V
	输出电流(Output current)	1.7	A
	输出总功率(Output total power)	89.66	W
R 输出参数 R output parameters	输入电流(Input Current)	0.925	A
	输入功率(input power)	22.2	W
	输出电压(The output voltage)	12	V
	输出电流(Output current)	1.718	A
	输出功率(Output total power)	20.62	W
G 输出参数 G output parameters	输入电流(Input Current)	1.5	A
	输入功率(input power)	36	W
	输出电压(The output voltage)	20	V
	输出电流(Output current)	1.728	A
	输出功率(Output total power)	34.56	W
B 输出参数 B output parameters	输入电流(Input Current)	1.494	A
	输入功率(input power)	35.86	W
	输出电压(The output voltage)	20	V
	输出电流(Output current)	1.725	A
	输出功率(Output total power)	34.48	W

注:

①本列表数据除特殊说明外, Ta:25°C,湿度<75%, 输入标称电压和输出额定负载时测得。

②本列表数据仅供参考, 实际以产品实物为标准, 偏差范围<5%。

Note:

1This list data is measured at Ta: 25 ° C, humidity < 75%, input nominal voltage and output rated load, unless otherwise specified.

2The data in this list is for reference only. The actual product is based on the standard, and the deviation range is <5%.

## 主板亮点 ( Motherboard highlights ) :

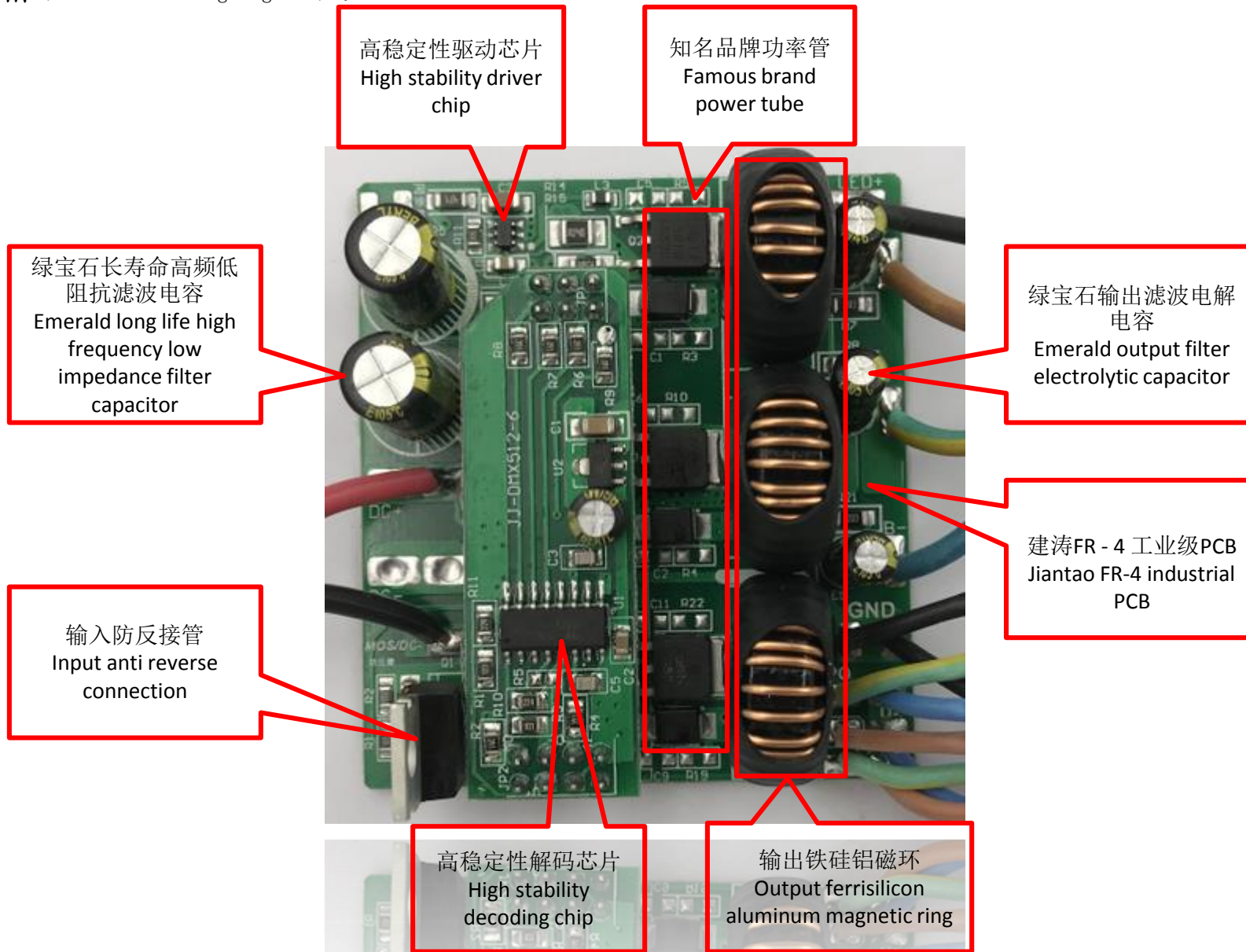

## 注 ( Note ) :

主板兼容多种控制方式: IR RF DMX512 RDM PWM (根据客户需求可定制)。

The motherboard is compatible with a variety of control methods: IR, RF, DMX512, RDM, PWM (customizable according to customer needs).

安装尺寸图 ( Installation dimension drawing ) :

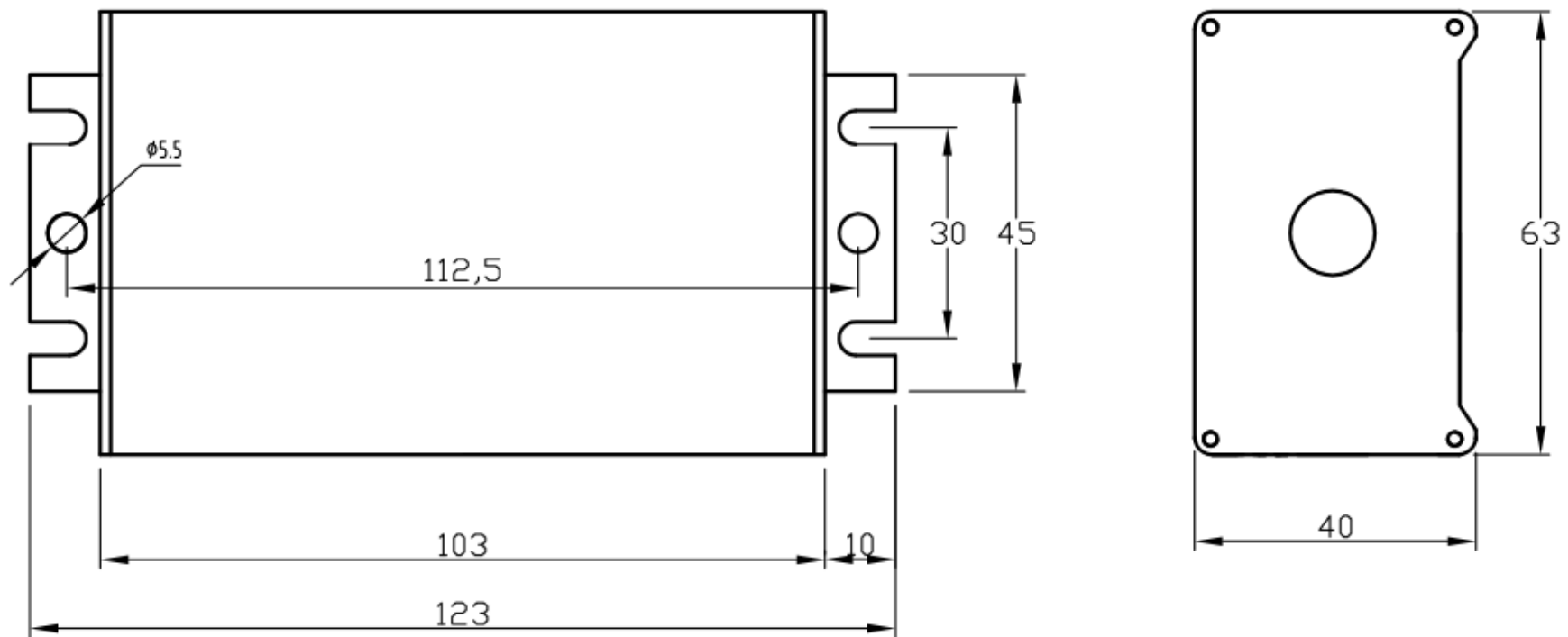

## 电源接线方式 (Power wiring mode) :

DC输入线材 (DC input wire)				
线材 (Wire rod)	标识 (Identification)	功能 (function)	线材颜色 (Wire color)	线材长度 (Wire length)
1	Red V+	直流正极输入 (DC positive input)	红色线 (Red line)	300mm±10mm
2	Black V-	直流负极输入 (DC negative input)	黑色线 (Black line)	
LED输出线材 (LED output wire)				
线材 (Wire rod)	标识 (Identification)	功能 (function)	线材颜色 (Wire color)	线材长度 (Wire length)
1	Black LED+	LED输出共正极 (LED output common positive)	黑色线 (Black line)	300mm±10mm
2	Red R-	红色LED负极 (Red LED negative)	红色线 (Red line)	
3	Green G-	绿色LED负极 (Green LED negative)	绿色线 (Green line)	
4	Blue B-	蓝色LED负极 (Blue LED negative)	蓝色线 (Blue line)	
DMX512信号输入线材 (DMX512 signal input wire)				
线材 (Wire rod)	标识 (Identification)	功能 (function)	线材颜色 (Wire color)	线材长度 (Wire length)
1	Brown A	DMX512信号正极 (DMX512 signal positive)	棕色线 (Brown line)	300mm±10mm
2	Blue B	DMX512信号负极 (DMX512 signal negative pole)	蓝色线 (Blue line)	
3	Black GND	DMX512信号地线 (DMX512 signal ground)	黑色线 (Black line)	
4	Green PI	DMX512信号写地址输入 (DMX512 signal write address input)	绿色线 (Green line)	
DMX512信号输出线材 (DMX512 signal output wire)				
线材 (Wire rod)	标识 (Identification)	功能 (function)	线材颜色 (Wire color)	线材长度 (Wire length)
1	Brown A	DMX512信号正极 (DMX512 signal positive)	棕色线 (Brown line)	300mm±10mm
2	Blue B	DMX512信号负极 (DMX512 signal negative pole)	蓝色线 (Blue line)	
3	Black GND	DMX512信号地线 (DMX512 signal ground)	黑色线 (Black line)	
4	Green Po	DMX512信号写地址输出 (DMX512 signal write address output)	绿色线 (Green line)	



## 产品使用说明(Product instructions):

★本产品只适用于LED灯具，（洗墙灯，投光灯，舞台灯等，景观亮化场所）整机功率为100W。

★产品输入端是交流电输入，对应产品标签上的AC“L”和AC“N”，输出端标识“LED+”、“R-”，“G-”，“B-”“W-”。“LED+”为输出（三色或四色）供阳端，接LED供阳正极，“R-”，“G-”，“B-”，“W-”为输出负极，接LED负极。

★本产品为防水产品，防水等级为IP67。

★安装时请注意安全，接高压电时，接头处做好加强绝缘防护，防止漏电。

★使用裸板时，请将产品做好绝缘处理。

注：在使用本电源时，请注意区分输入端和输出端，确定正确接线，核对无误在通电。

★ This product is only suitable for LED lamps, (wall washers, floodlights, stage lights, etc., landscape lighting places) the whole machine power is 100W .

★ The input of the product is the AC input, corresponding to AC "L" and AC "N" on the product label, and the output is labeled "LED+", "R-", "G-", "B-" "W-". "LED+" is the output (three or four colors) for the male end, and the LED is for the positive anode, "R-", "G-", "B-", "W-" for the output negative, connected to the LED negative .

★ This product is waterproof and has a waterproof rating of IP67.

★ Please pay attention to safety when installing. When connecting to high voltage, strengthen the insulation protection at the joint to prevent leakage.

★ When using bare boards, please insulate the product.

★ Note: When using this power supply, please pay attention to distinguish between the input terminal and the output terminal, determine the correct wiring, and verify that the power is on.

## 常见故障及处理方法(Common faults and treatment methods):

### 🔊 灯具不亮 The light is not bright

- 1 检查输入端接线是否有误  
Check if the input wiring is incorrect.
- 2 是否进入关机状态(RF版本)  
Whether to enter the shutdown state (RF version)
- 3 地址码是否正确(DMX版本)  
Is the address code correct (DMX version)

### 🔊 灯具抖闪 Lamp flashing

- 1 输入电压是否在产品工作位范围之内  
Is the input voltage within the product operating range?
- 2 灯具参数是否与驱动电压匹配  
Whether the lamp parameters match the driving voltage
- 3 LED灯线是否接触良好  
Is the LED light wire in good contact?